

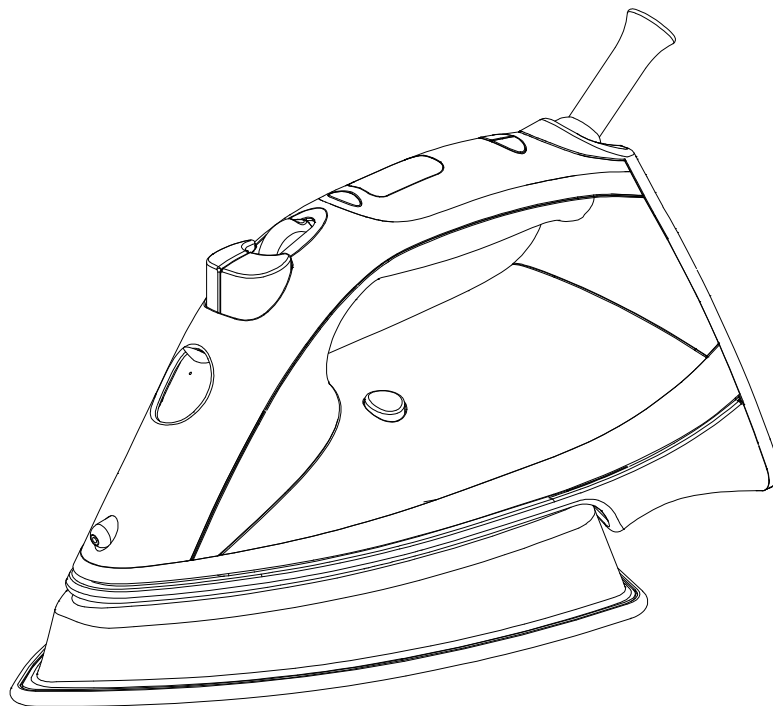

# DIGITAL IRON



**Item Stock Number**

169061

UPC : 681131690614

**For Customer Assistance, call Customer Service at  
1-877-207-0923 (US) or 1-877-556-0973 (Canada)**

## IMPORTANT SAFEGUARDS

When using electrical appliances especially when children are present, basic safety precautions should always be followed to reduce the risk of fire, electric shock, and/or injury to persons, including the following:

### READ ALL INSTRUCTIONS BEFORE USING THIS IRON

1. Use iron only for its intended use.
2. To protect against electrical shock, do not place cord, plug or iron in water or other liquids.
3. The iron should always be turned to "OFF" before plugging or unplugging from the outlet. Never yank the cord to disconnect from outlet, grasp plug and pull to disconnect.
4. Do not allow cord to touch hot surfaces. Let iron cool completely before putting away. Loop cord loosely around the iron when storing.
5. Always disconnect iron from electrical outlet when filling with water or emptying and when not in use.
6. Do not operate any appliance with a damaged cord or plug or after the appliance malfunctions, or has been damaged in any manner. Call our toll-free customer service number for information on examination, repair or adjustment.
7. To avoid the risk of electrical shock, do not disassemble the iron. Incorrect reassembly can cause a risk of electric shock when the iron is used.
8. Close supervision is necessary for any appliance being used by or near children.
9. Do not leave iron unattended while connected or on an ironing board.
10. Burns can occur from touching hot metal parts, hot water or steam. Use caution when you turn a steam iron upside down – there may be hot water in the reservoir.
11. Your iron is designed to rest on the heel rest. Do not leave the iron unattended. Do not set the iron on an unprotected surface, even if it is on its heel rest.
12. The use of accessory attachments not recommended by the appliance manufacturer may result in fire, electric shock or injury to persons.

## SAVE THESE INSTRUCTIONS!

### SPECIAL INSTRUCTIONS

1. To avoid an overloaded circuit, do not operate another high wattage appliance on the same electric circuit.
2. If an extension cord is absolutely necessary, a 13-ampere cord should be used. Cords rated for less ampereage may overheat. Care should be taken to arrange the cord so that it cannot be pulled or tripped over.

This appliance is for **HOUSEHOLD USE ONLY**. It may be plugged into an AC electrical outlet (ordinary household current). Do not use any other electrical outlet.

### CORD PLUG

This appliance has a polarized plug (one blade is wider than the other). To reduce the risk of electric shock, this plug is intended to fit into a polarized outlet only one way; if the plug does not fit fully into the outlet, reverse the plug. If it still does not fit, contact a qualified electrician. Do not attempt to defeat this safety feature.

### LINE CORD SAFETY TIPS

1. Never pull or yank on cord or the appliance.
2. To insert plug, grasp it firmly and guide it into outlet.
3. To disconnect appliance, grasp plug and remove it from outlet.
4. Before each use, inspect the line cord for cuts and/or abrasion marks. If any are found, this indicates that the appliance should be serviced and the line cord replaced.
5. Never wrap the cord tightly around the appliance, as this could place undo stress on the cord where it enters the appliance and cause it to fray and break.

**DO NOT OPERATE APPLIANCE IF THE LINE CORD SHOWS ANY DAMAGE, OR IF APPLIANCE WORKS INTERMITTENTLY OR STOPS WORKING ENTIRELY.**

## PARTS

1. Water Tank
2. Heel Rest
3. Soleplate
4. Self Clean Button
5. Spray Nozzle
6. Water Reservoir Cover
7. Burst of Steam Button
8. Spray Button
9. Variable Steam Dial
10. Fabric Selector Button
11. LCD Display
12. Dual Light: Power-Red  
Sleep Mode-Blue

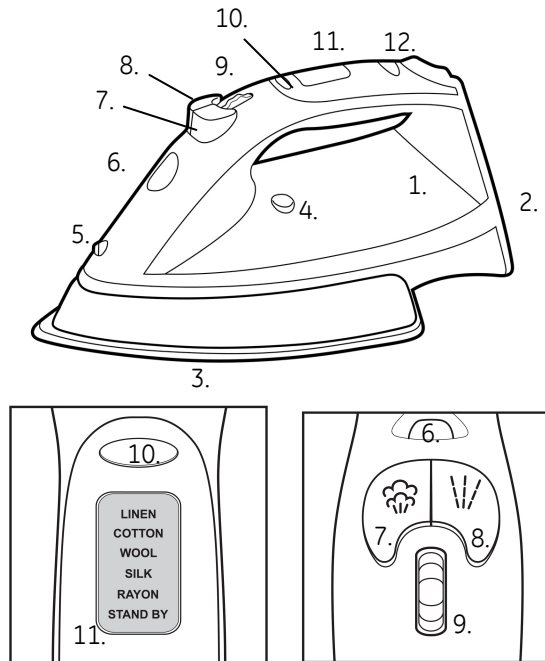

# FEATURES

## **SPRAY**

At any temperature, press the Spray button to dampen the fabric to aid in removing wrinkles from heavy fabrics and for setting creases.

## **SHOT OF STEAM**

1. Set the iron to the COTTON or LINEN setting
2. By pressing the Shot of Steam Button, an intense shot of steam is emitted from the soleplate.
3. This can be very useful when removing stubborn creases. The Shot of Steam can be used only while ironing with higher ironing temperatures.

## **VERTICAL STEAM**

1. Set the iron to the LINEN setting. The LCD background will be solid green and the word LINEN will blink.
2. Stand the iron on its heel rest.
3. When the iron reaches the proper temperature, there will be two audible beeps and the word LINEN will stop blinking.
4. Hold the iron vertically and press the Shot of Steam Button to emit an intense vertical steam from the soleplate.

## **SELF CLEAN (AUTO CLEAN SYSTEM)**

1. To prolong the life of your iron, we recommend that this should be carried out at regular intervals (once or twice a month).
2. Set the Continuous Rotary Knob to position "X".
3. Fill the water tank to "MAX".
4. Stand the iron on its heel rest.
5. Insert the plug into the wall socket.
6. Press the set button to select LINEN setting.
7. Unplug the iron and keep it horizontally over a sink.
8. Press the Self-Clean Button
9. Boiling water and steam will now be ejected from the steam vents in the soleplate.
10. Impurities and scale are washed away with the water.
11. Move the iron forward and backwards while this happens.
12. Release Self-Clean Button after one minute or when the Water Tank has become empty.
13. Stand the iron on its heel rest.
14. Insert the plug in to the wall socket and let the iron heat up again.
15. Move the iron over an old piece of cloth in order to let the remaining water vaporize.
16. Remove the plug from the wall outlet and wait for the soleplate to cool completely.
17. Make sure that the soleplate is completely dry before storing the iron.

## STEAM IRON MODEL

Model No.	Rated voltage	Rated power	Water Tank	Dimensions	Weight
169061	120V	1400W	400ml	11.75 x 5.25 x 5.75 (in)	4 LBS

## OPERATING INSTRUCTIONS

### USING THE WATER RESERVOIR:

- This iron can be used with normal tap water.
- If the water in your area is particularly hard, it is advisable to use distilled or de-mineralized water to prevent scale from forming.
- Do not use water that has passed through a home water softening system. This type of water contains minerals that will decrease the performance and shorten the life of your iron.

### **Filling:**

1. Ensure that the iron is disconnected from the power supply before filling. Turn the Continuous Steam Rotary Knob to "X" position, slide the Water Reservoir Cover down.
2. Fill water into the reservoir.
3. Close the Water Reservoir Cover.

### **Note:**

- Do not fill higher than indication "MAX" of the water tank in order to avoid spilling out of water.
- Do not fill with anything but water. If you have to refill while ironing, remove the main plug from the wall socket before filling.
- Pour any remaining water out after use.

### USING THE IRON:

#### **Ironing temperature:**

Always check first to see whether a label with ironing instructions is attached to the article to be ironed. Follow these instructions in all cases. If ironing instructions are missing but you do know the kind of fabric, then the table below may help you.

### Setting the temperature

- When pressing the Fabric Selector, the temperature setting will cycle in the following sequence:  
STAND BY → RAYON → SILK → WOOL → COTTON → LINEN → STAND BY

Setting	Temp. Range	LCD display action
Full display at initial stage		Power lamp will light and the system resets with LCD background ON and flashing once. Then the buzzer beeps once and it goes to the stand by condition with the Sleep Indication Lamp flashing blue.
Stand by condition		Hold Button for 3 Seconds to turn to Stand by. Background lamp turns off; the LCD will read "STAND BY" and Sleep Indication Lamp will flash blue. Under this condition, the relay has no output. If pressing on setting button, the system now goes to the ready operation status.
RAYON	195 - 250°F	Push button once: RAYON blinks until heat is reached and is ready to iron.
SILK	250-285°F	Push button twice: SILK blinks until heat is reached and is ready to iron
WOOL	285-320°F	Push button 3 times: WOOL blinks until heat is reached and is ready to iron
COTTON	320-355°F	Push button 4 times: COTTON blinks until heat is reached and is ready to iron.
LINEN	355-410°F	Push button 5 times: LINEN blinks until heat is reached and is ready to iron

### Dry Ironing

1. Plug the cord into a 120-volt AC outlet.
2. Make sure that the Continuous Steam Rotary Knob is in position "X".
3. By pressing the Fabric Selector button, select the setting best suited for the fabric to be ironed.

### Steam Ironing

1. Follow the instructions for filling the water reservoir.
2. Stand the iron on its heel rest.
3. Plug the cord into a 120-volt AC outlet.
4. Press the Fabric Selector button to reach the desired fabric setting.
5. Wait a few minutes for the indicator light to go out and come back on again. Set the Continuous Steam Rotary Knob to the required position, then the steam will emerge from the vents in the soleplate.

NOTE: It is recommended that the Burst of Steam button only be used when the fabric setting being used is COTTON or LINEN.

### SAFETY FEATURES:

**NOTE:** the iron will go into AUTO OFF mode if it is left unattended and will read "STAND BY" until the iron is moved again, or it automatically shuts off.

- **Sleep condition:** If the iron is left immobile for 30 seconds or in vertical position for 15 minutes, the LCD background will turn off and will flash "STAND BY" in ½ second intervals. Under this condition, the relay has no output and the buzzer will continuously beep for 2 seconds, then the iron will enter the sleep condition with the Sleep Indication Lamp (blue lamp) flashing.
- **Abnormal alarm:** If the sensor gets short-circuited or open circuited, or senses an abnormal temperature rise, it will alarm after 8 seconds with intermittent beeps in 3 second intervals. After alarm sounds, the LCD will have no display and the Sleep Indication lamp will flash blue. The buzzer will continue to beep until the abnormal situation is eliminated.

## CARING FOR YOUR IRON

### CLEANING:

- Before cleaning the iron, ensure that it is disconnected from the power supply and has completely cooled down.
- Deposits and other residues on the soleplate can be removed with a rough cloth soaked in a vinegar/water solution.
- The plastic casing may be wiped with a damp cloth and then polished with a dry one.
- Do not use abrasives on the soleplate.

### STORAGE:

- Set the Continuous Rotary Knob to position "X".
- Disconnect the plug from the wall socket.

- Stand the iron upright on its heel rest and allow to cool completely.
- Pour any remaining water out of the water tank.
- Loosely loop the power cord together and store the iron on its heel rest.

**IRONING TIPS:**

- Always read garment labels and follow the manufacturer's ironing instructions.
- Sort the articles to be ironed according to the type of fabric.
- You should first iron garments requiring low temperatures to avoid damaging them with an iron that is too hot.
- If you are unsure of the fabric content of the garment, test a small area, such as a seam or facing, before ironing a visible area. Start with a low temperature and gradually increase the heat to find the best setting.
- When changing the temperature from a high setting to a low setting, allow approximately 5 minutes for the lower temperature to be reached.
- When steam ironing, use long, slow passes over the fabric. This will allow the steam to penetrate the fabric while allowing the heat of the soleplate to dry out the moisture.
- To iron linens, turn garment inside out. Be careful not to use an iron that is too hot because the lining may melt or stick to the soleplate.
- Never iron over zippers, pins, snaps, or anything metal as this may scratch or damage the soleplate.



# CUSTOMER ASSISTANCE

If you have a claim under this warranty, please call our Customer Assistance Number. For faster service, please have the model, type and series numbers ready for the operator to assist you. These numbers can be found on the bottom of your appliance.

MODEL : \_\_\_\_\_ TYPE : \_\_\_\_\_ SERIES : \_\_\_\_\_

Customer Assistance Number 1-877-207-0923 (US) or 1-877-556-0973 (Canada)

Keep these numbers for future reference!

For more information, please visit us at [www.walmart.com](http://www.walmart.com)

## TWO- YEAR LIMITED WARRANTY

### What does your warranty cover?

- Any defect in material or workmanship.

### For how long after the original purchase?

- Two years.

### What will we do?

- Provide you with a new one!
- For those items still under warranty but no longer available, WAL-MART reserves the right to replace with a similar GE branded product of equal or greater value.

### How do you make a warranty claim?

- Save your receipt.
- Properly pack your unit. We recommend using the original carton and packing materials.
- Return the product to your nearest WAL-MART store or call Customer Assistance at 1-877-207-0923 (US) or 1-877-556-0973 (Canada)

### What does your warranty not cover?

- Parts subject to wear, including, without limitation, glass parts, glass containers, cutter/strainer, blades, seals, gaskets, clutches, motor brushes, and/or agitators, etc.
- Commercial use or any other use not found in printed directions.
- Damage from misuse, abuse, or neglect, including failure to clean product regularly in accordance with manufacturer's instructions.

### How does state law relate to this warranty?

- This warranty gives you specific legal rights, and you may also have other rights which vary from state to state or province to province.
- THIS WARRANTY IS IN LIEU OF ANY OTHER WARRANTY OR CONDITION, WHETHER EXPRESS OR IMPLIED, WRITTEN OR ORAL, INCLUDING, WITHOUT LIMITATION, ANY STATUTORY WARRANTY OR CONDITION OF MERCHANTABILITY OR FITNESS FOR A PARTICULAR PURPOSE.
- WAL-MART, GE AND THE PRODUCT MANUFACTURER EXPRESSLY DISCLAIM ALL RESPONSIBILITY FOR SPECIAL, INCIDENTAL AND CONSEQUENTIAL DAMAGES OR LOSSES CAUSED BY USE OF THIS APPLIANCE. ANY LIABILITY IS EXPRESSLY LIMITED TO AN AMOUNT EQUAL TO THE PURCHASE PRICE PAID WHETHER A CLAIM, HOWEVER INSTITUTED, IS BASED ON CONTRACT, INDEMNITY, WARRANTY, TORT (INCLUDING NEGLIGENCE), STRICT LIABILITY OR OTHERWISE. SOME STATES OR PROVINCES DO NOT ALLOW THIS EXCLUSION OR LIMITATION OF INCIDENTAL OR CONSEQUENTIAL LOSSES SO THE FOREGOING DISCLAIMER MAY NOT APPLY TO YOU.

### What if you encounter a problem with this product while using it outside the country of purchase?"

- The warranty is valid only in the country of purchase and you follow the warranty claim procedure as noted.



is a trademark of General Electric Company and is used under the license by Wal-Mart Stores Inc., Bentonville, AR 72716

### Marketed in Canada by:

Wal-Mart Canada Corp.  
1940 Argenta Road, Mississauga, Ontario L5N1P9